

Chelsea Space

BRODY CHIPCHASE / ISOBEL FINLAY

David Troostwyk / Matt's Gallery Studio Award & Vanguard Prize Winners 2020

Exhibition Dates: 9 November – 11 December 2020

This autumn, **Chelsea Space** in collaboration with Camberwell College of Arts is delighted to host an exhibition of new work by **Brody Chipchase and Isobel Finlay**, winners of **The David Troostwyk / Matt's Gallery Studio Award** and **The Vanguard Prize** respectively. The exhibition sees these two artists, both recent graduates from BA courses at Camberwell College of Arts, come together to showcase and celebrate the culmination of their individual year-long studio residencies. In response to the current access restrictions, Chelsea Space is hosting this exhibition to enable on street viewing via the gallery's large window frontage.

Brody Chipchase presents a new body of work inspired by objects known as tongue stones - curiosities thought to have fallen from the moon and offer protection from poison. Regarded as mystical treasures from the sky, they were in reality the fossilised teeth of prehistoric creatures. Chipchase presents objects from an imagined world where teeth are the most valuable offerings, collected and scavenged by creatures known as The Tooth Collectors. These relics are the only known evidence that such a place exists.

By fashioning her own mythology and visual language through an assemblage of other-worldly objects and talismans, the artist harbours an archive of artefacts from an unknown realm and ambiguous time encompassing both past and future. Offerings of teeth and bones, ceremonial vessels and globulous idols are some of the curiosities found within this world. The collection of relics, positioned in conversation with each other, allows the artist to explore narrative elements that allude to suggestive storylines without providing us with a fully comprehensive tale. The work presents itself as props to be played with, and like props they act as signifiers to a larger world.

Isobel Finlay is interested in how craft skills reflect the body's natural rhythms, and how these rhythms can be distorted by modern living and materials. Fabric production was, up until relatively recently, something that would have been done in the home and is inextricably tied to our bodies; fabric literally houses us daily as clothing, protects us and is a form of personal expression. Fabric we create or wear holds a part of us within it.

Describing her process, the artist writes, 'I offer myself to the world, and it changes and distorts me. Up then down. Left to right. Again and again and again. Memories buried in muscles, twitches of fingers mimicking the ghosts that have gone before. Memories held in the making, the future tumbling from needles that press into the past. Twisted, taut, trembling - the skin of my cloth supporting the things that have come before. Change is inevitable. The hard, unwavering materials of our architecture bleed into us, leave their mark in calcifying scars. We stretch out to meet the boundary, sacrifice little offerings of ourselves, and the metamorphosis begins'.

Chelsea Space
Chelsea College of Arts,
16 John Islip Street,
London SW1P 4JU
www.chelseaspace.org

ual: camberwell
chelsea
wimbledon

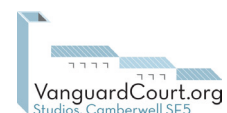

LIST OF WORKS

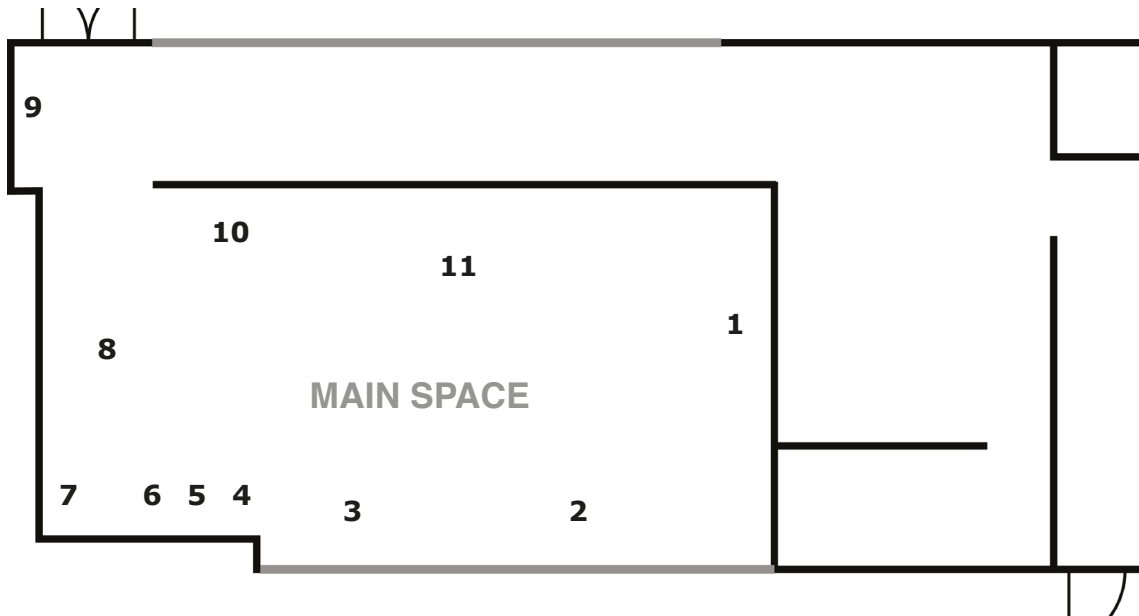

List of works (clockwise from right wall):

- 1) Isobel Finlay, Vortex, 2020, plaster and synthetic fibres
- 2) Brody Chipchase, Untitled, 2020, glazed ceramics, pewter, salt dough, hessian rope, plywood
- 3) Isobel Finlay, Awenyddoin (We Have Forgotten, Old Light), 2020, plaster, synthetic fibres, hand woven steel
- 4) Brody Chipchase, Untitled, 2020, glazed ceramics, pewter, salt dough, hessian rope, plywood
- 5) Brody Chipchase, Untitled, 2020, glazed ceramics, pewter, salt dough, hessian rope, plywood
- 6) Brody Chipchase, Untitled, 2020, glazed ceramics, pewter, salt dough, hessian rope, plywood
- 7) Brody Chipchase, X9430-03, 2020, plaster, pewter, aluminium, salt dough, motors, electronics, nuts and bolts
- 8) Brody Chipchase, Untitled, 2020, glazed ceramics, pewter, salt dough, hessian rope, plywood
- 9) Brody Chipchase, X9430-01, 2020, plaster, pewter, aluminium, salt dough, motors, electronics, nuts and bolts
- 10) Brody Chipchase, Brody Chipchase, Untitled, 2020, glazed ceramics, pewter, salt dough, hessian rope, plywood
- 11) Brody Chipchase, X389-02, 2020, plaster, pewter, aluminium, salt dough, motors, electronics, nuts and bolts